

轴向盘编规格 Axial Lead Taping Specifications For Rectifiers

Axial lead devices are packed in accordance with EIA standard RS-296-D and specifications given below

COMPONENT OUTLINE	COMPONENT PITCH A	INNER TAPE PITCH B		CUMULATIVE PITCH TOLERANCE
	±0.5mm(.020'')	±1.5mm(.020'')	±0.5mm(.020'')	
DO-34/DO-35	5.0mm	26.0mm		2.0mm/20pitch
R-1	5.0mm	26.0mm		2.0mm/20pitch
A-405	5.0mm	26.0mm		2.0mm/20pitch
A-405	5.0mm		52.4mm	2.0mm/10pitch
DO-41	5.0mm	26.0mm		2.0mm/20pitch
DO-41	5.0mm		52.4mm	2.0mm/10pitch
DO-15	5.0mm		52.4mm	2.0mm/10pitch
DO-201AD	10.0mm		52.4mm	2.0mm/10pitch
R-6	10.0mm		52.4mm	2.0mm/10pitch

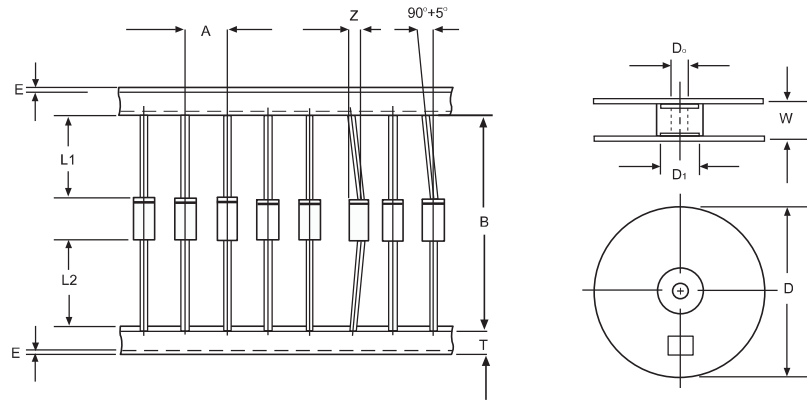

FIG : CONFIGURATION OF AXIAL TAPING

ITEM	SYMBOL	SPECIFICATIONS(mm)	SPECIFICATIONS(inch)
Component alignment	Z	1.2max	0.048max
Tape width	T	6.0±0.4	0.236±0.016
Exposed adhesive	E	0.8max	0.032max
Body eccentricity	IL1-L2I	1.0max	0.040max
Reel outside diameter	D	330.0	13.0
Reel inner diameter	D ₁	85.7±0.3	3.375±0.012
Feed hole diameter	D ₀	30.5±0.4	1.201±0.016
Reel width	W	79.0±1.0	3.110±0.040

NOTE:1.Each component lead shall be sandwiched between tapes for A minimum of 3.2mm(0.126'')

2.The reel "w" for 26mm taping 50.0±1.0mm(1.970'±0.040'')

轴向编带规格 Ammo Box Packaging Specifications For Axial Lead Rectifiers

Axial lead devices are packed in accordance with EIA standard RS-296-D and specifications given below

COMPONENT OUTLINE	COMPONENT PITCH A	INNER TAPE PITCH B	CUMULATIVE PITCH TOLERANCE
	±0.5mm(.020'')	+0.5mm(.020'')	
R-1	5.0mm	26.0mm	2.0mm/20pitch
R-1	5.0mm	52.4mm	2.0mm/10pitch
A-405	5.0mm	26.0mm	2.0mm/20pitch
A-405	5.0mm	52.4mm	2.0mm/10pitch
DO-34/DO-35	5.0mm	26.0mm	2.0mm/20pitch
DO-34/DO-35	5.0mm	52.4mm	2.0mm/10pitch
DO-41	5.0mm	26.0mm	2.0mm/20pitch
DO-41	5.0mm	52.4mm	2.0mm/10pitch
DO-15	5.0mm	52.4mm	2.0mm/10pitch
DO-27	10.0mm	52.4mm	2.0mm/10pitch
R-6	10.0mm	52.4mm	2.0mm/10pitch

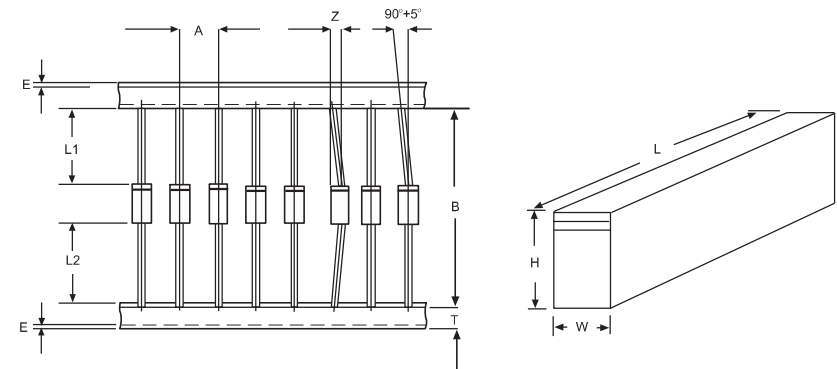

ITEM	SYMBOL	SPECIFICATIONS(mm)	SPECIFICATIONS(inch)
Component alignment	Z	1.2max	0.048max
Tape width	T	6.0±0.4	0.236±0.016
Exposed adhesive	E	0.8max	0.032max
Body eccentricity	IL1-L2I	1.0max	0.040max
Box length	L	255.0±5.0	10.04±0.197
Box width	W	78.0±5.0	3.07±0.197
Box height	H	150.0±5.0	5.91±0.197

NOTE:Each component lead shall be sandwiched between tapes for A minimum of 3.2mm(0.126'')

表面贴装二极管包装规格 Reel Taping Specifications For Surface Mount Devices-Flat Melf

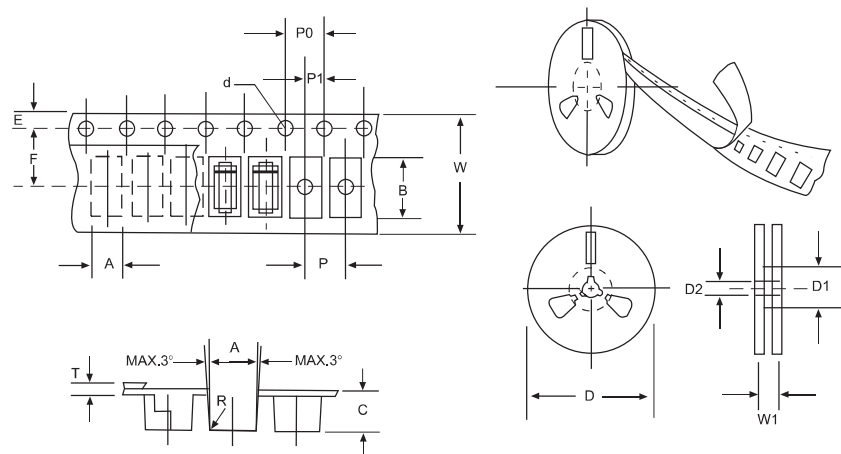

Fig:CONFIGURATION OF FLAT MELF TAPING (SMA/SMB/SMC)

ITEM	SYMBOL	SMA mm(inch)	SMB mm(inch)	SMC mm(inch)
Carrier width	A	2.79±0.1(0.110±0.004)	4.09±0.1(0.161±0.004)	6.05±0.1(0.238±0.004)
Carrier length	B	5.33±0.1(0.210±0.004)	5.82±0.1(0.229±0.004)	8.31±0.1(0.327±0.004)
Carrier depth	C	2.36±0.1(0.093±0.004)	3.33±0.1(0.131±0.004)	2.50±0.1(0.100±0.004)
Sprocket hole	d	1.5±0.05(0.059±0.002)	1.55±0.05(0.061±0.002)	1.5±0.1(0.059±0.004)
Reel outside diameter	D	330/178±2.0(13/7.0±0.79)	330/178±2.0(13/7.0±0.79)	330/178±2.0(13/7.0±0.79)
Reel inner diameter	D1	8.0±0.2(0.315±0.008)	8.0±0.2(0.315±0.008)	8.0±0.2(0.315±0.008)
Feed hole diameter	D2	13±0.5(0.512±0.020)	13±0.5(0.512±0.020)	13±0.5(0.512±0.020)
Strocket hole position	E	1.75±0.1(0.069±0.004)	1.75±0.1(0.069±0.004)	1.5±0.1(0.059±0.004)
Punch hole position	F	5.5±0.05(0.217±0.002)	5.65±0.05(0.222±0.002)	7.65±0.05(0.301±0.002)
Punch hole pitch	P	4.0±0.1(0.157±0.004)	8.0±0.1(0.315±0.004)	8.0±0.1(0.315±0.004)
Sprocket hole pitch	P0	4.0±0.1(0.157±0.004)	4.0±0.1(0.157±0.004)	4.0±0.1(0.157±0.004)
Embossment center	P1	2.0±0.1(0.079±0.004)	2.0±0.1(0.079±0.004)	2.0±0.1(0.079±0.004)
Totall tape thickness	T	0.28±0.02(0.011±0.0008)	0.32±0.1(0.013±0.004)	0.3±0.1(0.012±0.004)
Tape width	W	12.0±0.2(0.472±0.008)	12.0±0.2(0.472±0.008)	16.0±0.2(0.630±0.008)
Reel width	W1	16.8±2.0(0.661±0.079)	16.8±2.0(0.661±0.079)	24.0±2.0(0.945±0.079)

NOTE: Devices are packde in accordance with EIA standard RS-481-A and specification given above.

表面贴装二极管包装规格 Reel Taping Specifications For Surface Mount Devices-Melf

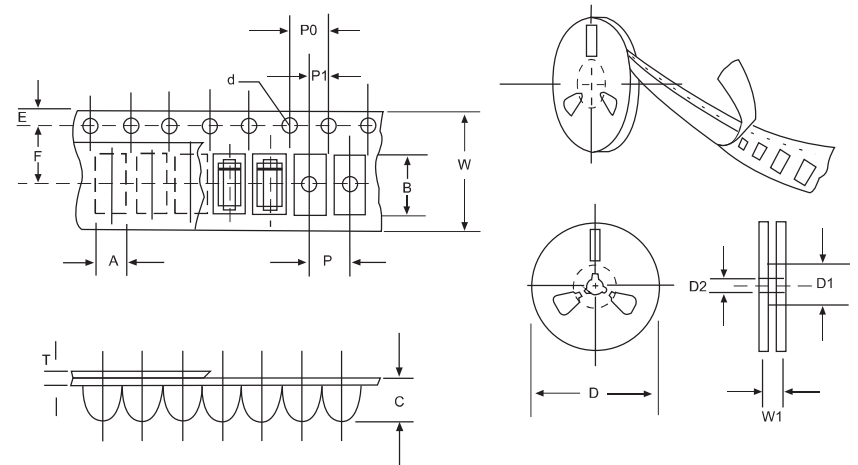

Fig:CONFIGURATION OF FLAT MELF TAPING

ITEM	SYMBOL	SPECIFICATIONS(mm)	SPECIFICATIONS(inch)
Carrier width	A	3.2max.	0.126max.
Carrier length	B	7.8max.	0.307max.
Carrier depth	C	4.5max.	0.177max.
Sprocket hole	d	1.5±1.0	0.059+0.004
Reel outside diameter	D	178±2.0	7.0±0.79
Reel inner diameter	D1	50min.	1.969max.
Feed hole diameter	D2	13.0±0.5	0.512±0.020
Strocket hole position	E	1.75±0.1	0.069±0.004
Punch hole position	F	5.5±0.1	0.217±0.004
Punch hole pitch	P	4.0±0.1	0.157±0.004
Sprocket hole pitch	P0	4.0±0.1	0.157±0.004
Embossment center	P1	2.0±0.05	0.079±0.002
Totall tape thickness	T	1.1max.	0.043max.
Tape width	W	12.0+0.3	0.472±0.012
Reel width	W1	10.4max.	0.724max.

NOTE: 1.Devices are packed in accordance with EIA standard RS-481-A and specifications given above
 Aailable only for MELF devices.
 2.Available on 7 inch (1500 ct.) or 13 inch (5000 ct.) diameter reels.

SOD-123包装规格 Reel Taping Specifications For SOD-123 Packaging Diodes-Melf

SOD123 Embossed Carrier Tape Configuration: Figure 3.0

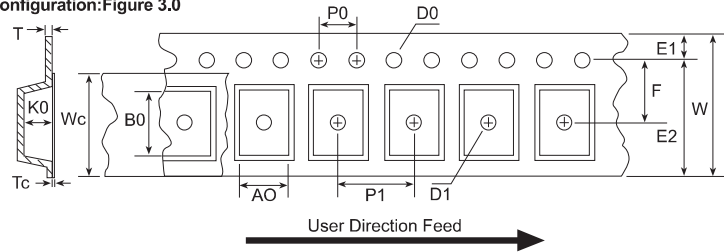

Dimensions are millimeter

Pkg type	A0	B0	W	D0	D1	E1	E2	F	P1	P0	K0	T	Wc	Tc
SOD123 (8mm)	1.85 +/-0.10	3.94 +/-0.10	8.0 +/-0.3	1.50 +/-0.125	1.125 +/-0.125	1.75 +/-0.10	6.25 min	3.50 +/-0.05	4.0 +/-0.10	4.0 +/-0.10	1.50 +/-0.10	0.20 +/-0.020	5.2 +/-0.20	0.06 +/-0.02

Notes: A0, B0 and K0 dimensions are determined with respect to the EW. Jecdec RS-481 rotational and lateral movement requirements (see sketches A, B and C).

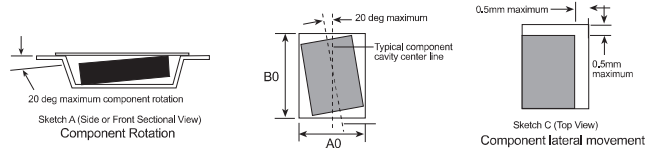

SOD123 Reel Configuration: Figure 4.0

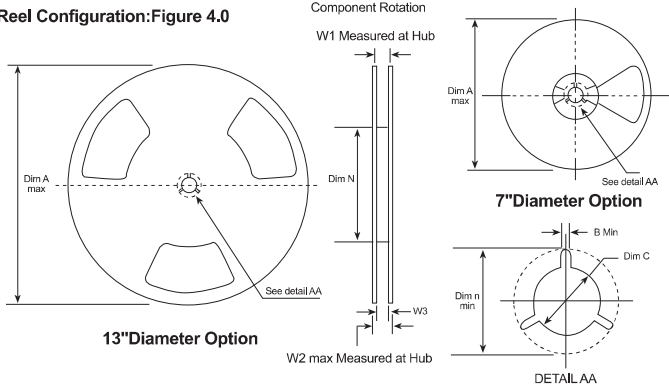

Dimensions are in inches and millimeter

Type Size	Reel Option	Dim A	Dim B	Dim C	Dim D	Dim N	Dim W1	Dim W2	Dim W3 (LSL-USL)
8mm	7" Dia	7.00 177.8	0.059 1.5	512+0.020/-0.008 13+0.5/-0.2	0.795 20.0	2.165 55	0.331+0.059/-0.000 8.4+1.5/0	0.567 14.4	0.311-0.429 7.9-10.9
8mm	13" Dia	13.00 330	0.059 1.5	512+0.020/-0.008 13+0.5/-0.2	0.795 20.0	4.00 100	0.331+0.059/-0.000 8.4+1.5/0	0.567 14.4	0.311-0.429 7.9-10.9

SOD-323包装规格 Reel Taping Specifications For SOD-323 Packaging Diodes-Melf

SOD323 Embossed Carrier Tape Configuration: Figure 3.0

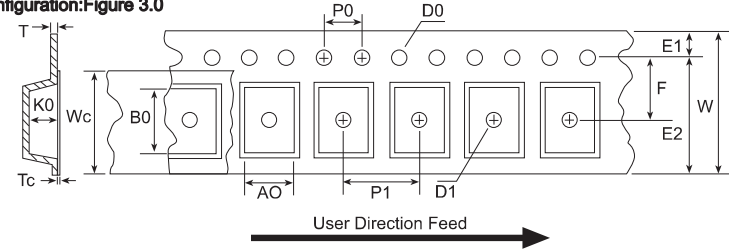

Dimensions are millimeter

Pkg type	A0	B0	W	D0	D1	E1	E2	F	P1	P0	K0	T	Wc	Tc
SOD323 (8mm)	1.46 +/-0.10	2.9 +/-0.10	8.0 +/-0.3	1.50 +/-0.125	1.125 +/-0.125	1.75 +/-0.10	6.25 min	3.50 +/-0.05	4.0 +/-0.10	4.0 +/-0.10	1.25 +/-0.10	0.25 +/-0.020	5.2 +/-0.20	0.06 +/-0.02

Notes: A0, B0 and K0 dimensions are determined with respect to the EW. Jecdec RS-481 rotational and lateral movement requirements (see sketches A, B and C).

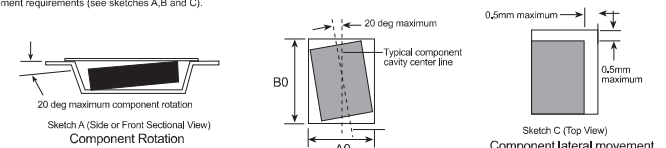

SOD323 Reel Configuration: Figure 4.0

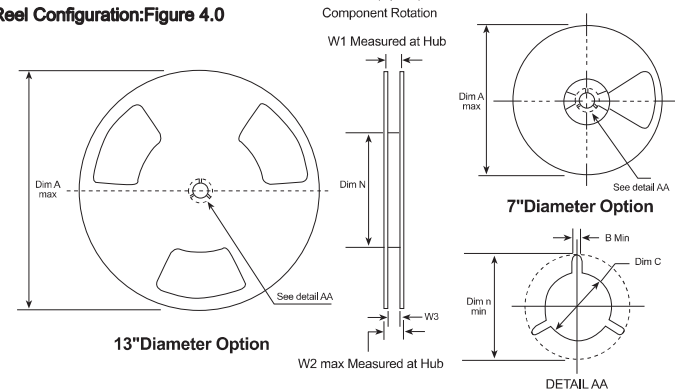

Dimensions are in inches and millimeter

Type Size	Reel Option	Dim A	Dim B	Dim C	Dim D	Dim N	Dim W1	Dim W2	Dim W3 (LSL-USL)
8mm	7" Dia	7.00 177.8	0.059 1.5	512+0.020/-0.008 13+0.5/-0.2	0.795 20.0	2.165 55	0.331+0.059/-0.000 8.4+1.5/0	0.567 14.4	0.311-0.429 7.9-10.9
8mm	13" Dia	13.00 330	0.059 1.5	512+0.020/-0.008 13+0.5/-0.2	0.795 20.0	4.00 100	0.331+0.059/-0.000 8.4+1.5/0	0.567 14.4	0.311-0.429 7.9-10.9

二极管和整流桥的包装规格 Packaging Of Diodes And Bridge Rectifiers

二极管和整流桥的包装规格 Packaging Of Diodes And Bridge Rectifiers

BULK PACK(B/P) 散装

PACKAGE 封装形式	EA PER BOX 每盒(EA)	INNER BOX SIZE 内盒尺寸(mm)	CARTON SIZE 外箱尺寸(mm)	EA PER CARTON 每箱(EA)	GROSS WEIGHT 总重(kg)
R-1	1,000	198*86*21	460*220*250	50,000	12.00
A-405	1,000	198*86*21	460*220*250	50,000	13.80
DO-41	1,000	198*86*21	460*220*250	50,000	20.00
DO-15	500	198*86*21	460*220*250	25,000	13.20
DO-201AD	200	198*86*21	460*220*250	10,000	14.00
R-6	200	300*75*40	350*320*275	4,800	12.78
DO-34	10,000	240*100*100	410*350*275	120,000	21.5
DO-35	10,000	240*100*100	410*350*275	120,000	21.5
DO-41(G)	5,000	240*100*100	410*350*275	60,000	26.5
RS-2	400	212*165*55	465*220*260	4,000	13.04
GBJ4	300	320*140*40	330*315*235	3,000	14.4
GBJ6	250	310*145*43	330*325*210	2,000	14.9
GBU	250	232*114*43	245*245*200	2,000	9
KBP	500	203*203*35	435*215*210	5,000	10.65
KBPC1	200	203*203*44	435*215*250	2,000	7.93
KBPC25	50	203*203*44	435*215*250	500	15.2
KBPC25-W	50	194*194*44	425*215*240	10,000	13.7
KBPC6	200	203*203*35	435*215*210	2,000	7.56
KBPC8	200/300	230*230*35	490*240*205	2,000/3,000	11.6
KBL	500	203*203*44	430*220*200	4,000	18.4
KBU	400	233*213*55	450*250*190	2,400	17.98
WOB	1,000	260*190*70	420*400*280	10,000	13

TUBE PACK 管装

PACKAGE 封装形式	EA PER BOX 每盒(EA)	INNER BOX SIZE 内盒尺寸(mm)	CARTON SIZE 外箱尺寸(mm)	EA PER CARTON 每箱(EA)	GROSS WEIGHT 总重(kg)
TO-220(A)	1,000	555*145*40	557*230*170	5,000	14.15
MBM	5,000	510*110*49	530*240*185	30,000	8.97
DBS	5,000	462*130*62	475*280*155	10,000	13
DB	2,500	462*130*62	475*280*155	5,000	7.7

REEL PACK(T/R) 盘编

PACKAGE 封装形式	EA PER BOX 每盒	COMPONENT SPACE(mm) 器件间距	TAPE SPACE (mm) 编带间距	REEL DIA(mm) 卷盘直径	CARTON SIZE (mm) 外箱尺寸	EA PER CARTON 每箱	GROSS WEIGHT(kg) 总重
R-1	5000	5.0	52	330	350*345*430	25,000	9.50
A-405	5,000	5.0	52	330	350*345*430	25,000	12.00
DO-41	5,000	5.0	52	330	350*345*430	25,000	13.00
DO-15	4,000	5.0	52	330	350*345*430	20,000	12.50
DO-201AD	1,500	9.5	52	330	350*345*430	7,500	13.00
R-6	500	9.5	52	330	355*360*345	2,500	7.45
DO-34	10,000	5.0	52	360	380*380*420	50,000	13
DO-35	10,000	5.0	52	360	380*380*420	50,000	13
DO-41(G)	5,000	5.0	52	36	380*380*420	25,000	14.5
SMA/SMA(G)	7,500(13")	-	-	330	365*365*360	120,000	17
SMA/SMA(G)	5,000(11")	-	-	280	310*310*360	80,000	12
SMA/SMA(G)	2,000(7")	-	-	178	390*265*400	100,000	13
SMB/SMB(G)	3,000	-	-	330	365*365*360	48,000	15
SMC(G)	3,000	-	-	330	365*365*340	48,000	15
SOD-123	3,000	-	-	330	430*430*235	180,000	9
SOD-323	3,000	-	-	330	430*430*235	180,000	8
SOD-123FL	3,000	-	-	330	430*430*235	180,000	9
ABS	4,000	-	-	-	360*360*360	64,000	15
MBS	3,000	-	-	-	360*360*360	48,000	14

AMMO PACK(T/B) 盒装

PACKAGE 封装形式	REEL (EA) 每条	COMPONENT SPACE(mm) 器件间距	TAPE SPACE (mm) 编带间距	BOX SIZE (mm) 内盒尺寸	CARTON SIZE (mm) 外箱尺寸	EA PER CARTON 每箱	GROSS WEIGHT(kg) 总重
R-1	5,000	5.0	52	255*74*145	410*275*340	50,000	11.13
A-405	5,000	5.0	52	255*74*145	410*275*340	50,000	11.13
DO-41	5,000	5.0	52	255*74*145	410*275*340	50,000	15.17
DO-15	3,000	5.0	52	255*74*145	410*275*340	30,000	15.17
DO-201AD	1,250	9.5	52	255*74*145	410*275*340	12,500	15.17
R-6	500	9.5	52	255*74*145	410*275*340	5,000	8.10
DO-34	5,000	5.0	52	255*80*80	410*275*350	100,000	18
DO-35	5,000	5.0	52	255*80*80	410*275*350	100,000	20
DO-41(G)	5,000	5.0	52	255*80*80	410*275*350	50,000	22
R-1	2,500	5.0	26	255*50*95	500*265*310	67,500	13
A-405	2,500	5.0	26	255*50*95	500*265*310	67,500	13
DO-41	3,000	5.0	26	255*50*95	500*265*310	81,000	22